

KOBELCO

CONSTRUCTION MACHINERY LINE-UP 2021



Complies with the EU Stage V
exhaust emission regulation

We Save You Fuel

Achieving a Low-Carbon Society

Superb, Uniform Quality



Japan's first electric shovel in 1930

In 1930, Kobe Steel manufactured Japan's first domestically produced electric shovel, followed by Japan's first hydraulic excavator in 1963. Since then, the KOBELCO brand has been associated with groundbreaking construction machinery ranging from civil engineering equipment to machines used in recycling operations.

In developing new products, we always start with actual worksites. What do owners and operators really need in today's market? What are the onsite conditions, and how can we make operations easier, faster, and more efficient? By asking the right questions from the start, we've created an impressive lineup of machines that have won international praise for their excellent performance, fuel efficiency, and whisper-quiet operation.



Around the Globe

We are always prepared to conduct research and development from the customer's perspectives. We create new values by further deepening the ingenious technology we have developed to date as well as effectively using the latest technology such as three- dimensional CAD and structural analysis and basic research.

We have an ideal system tailored to customer needs. Those needs are analyzed at worksites throughout the world, forming the basis for developmental work at Production Division and the Product Development Engineering Division and the new plant, including the invention of efficient production technologies. We then transfer the results to our various production centers throughout the world, making it possible for us to quickly and reliably deliver machines featuring unprecedented fuel efficiency, productivity, durability, and advanced technology to customers around the globe.



Hiroshima Headquarters



Itsukaichi Factory in Hiroshima

PERFORMANCE × DESIGN

Experiencing a competent performance

SK500LC/SK530LC of KOBELCO has realised a completely new value by harmonising PERFORMANCE – greater efficiency and productivity with an increased power and speed and DESIGN – operator-based operability and comfort, refusing to accept any compromises. In pursuit of unique and matchless machines which are unforgettable once you use them, KOBELCO will continue to rise to meet every challenge.



SK500LC SK530LC

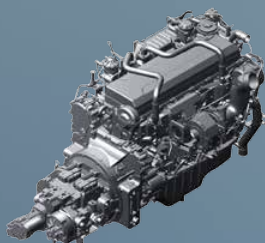

Model: HINO E13CYM

Engine output

300 kW / 1,900 min⁻¹ (ISO 14396)

>>> Cycle time

(1. Digging | 2. 90° swing | 3. Dumping | 4. 90° swing)

< H-mode >

Shortened by **5.1%**

(Compared to H-mode on SK500LC-10)

>>> Fuel consumption

(Fuel usage per hour)

< S-mode >

Improved by **5.4%**

(Compared to S-mode on SK500LC-10)

>>> Productivity

(Digging volume / Fuel)

< Eco-mode >

Increased by **6.2%**

(Compared to Eco-mode on SK500LC-10)

SK530LC (MVLC)

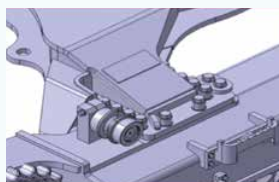

Crawler width can be adjusted by fixing bolt positions to comply with transport regulations.

*MVLC is standard equipment for SK530LC.

CONVENTIONAL SERIES

Independent Travel

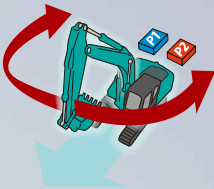

Selecting Independent Travel dedicates one hydraulic pump to travel and one to the attachment on a continuous basis, allowing for a smooth and constant movement speed even while swinging or using the boom or attachment. With Independent Travel, safely carrying a large pipe across a job site is a breeze.



Heavy Lift



High hydraulic pressure (Heavy Lift) means greater lifting power, at close radius, allowing for smooth and steady operation while moving heavy objects.

Swing Priority

Our exclusive system automatically and instantly delivers full swing power during combined operations. There's no need to switch modes to make quick work of jobs like side-digging and back-filling.

Greater Multi-function Capabilities

Attachment mode

The flow-rate modes of the bucket, breaker, nibbler, and rotating grapple are set before delivery, which allows you to start operating immediately. Mode settings for other attachments, such as the tilt rotator, can easily be added or changed.



Adjustment for hydraulic flow

Divide ratio of hydraulic flow can be adjusted by service staff for custom usage.



CONVENTIONAL SERIES

Performance  Design



SK130_{LC}



SK180_{LC}

NEW

Performance  Design



SK210_{LC}

Model		SK130LC	SK180LC SK180N	SK210LC SK210NLC
Bucket Capacity	m ³	0.24 - 0.70	0.63	0.8
Engine Power (ISO 14396)	kW/min ⁻¹	78.5/2,000	100/2,000	124/2,000
Operating weight	kg	14,700	19,600/18,800	21,900
Bucket Digging Force	kN	105.4	114/126*	143/157*
Arm Crowding Force	kN	64.0	82.3/90.6*	102/112*
Overall Length	mm	7,770	8,700	9,600
Overall Width	mm	2,590	2,800/2,490	2,990/2,800
Overall Height	mm	3,150	3,080	3,060

*Power Boost engaged

SK260_{LC}



SK300_{LC}



NEW

Performance  Design

SK350_{LC}



Model		SK260LC SK260NLC	SK300LC SK300NLC	SK350LC SK350NLC
Bucket Capacity	m ³	1.0	1.2	1.4
Engine Power (ISO 14396)	kW/min ⁻¹	138/2,100	200/2,100	213/2,100
Operating weight	kg	26,200/26,100	30,000/29,800	36,700/36,600
Bucket Digging Force	kN	170/187*	188/208*	222/244*
Arm Crowding Force	kN	122/134*	126/139*	163/180*
Overall Length	mm	10,210	10,710	11,300
Overall Width	mm	3,190/2,990	3,190/2,990	3,190/2,990
Overall Height	mm	3,220	3,270	3,200

*Power Boost engaged

CONVENTIONAL SERIES

NEW

Performance  Design



SK500_{LC} **SK530_{LC}**

Model	SK500LC	SK500LC ME	SK530LC	SK530LC ME
Bucket Capacity	m ³ 1.9	3.4	1.9	3.4
Engine Power (ISO 14396)	kW/min ⁻¹	300/1,900		
Operating weight	kg 50,600	52,600	52,100	52,500
Bucket Digging Force	kN 267/292*	288/312*	267/292*	288/312*
Arm Crowding Force	kN 203/222*	247/270*	203/222*	247/270*
Overall Length	mm 12,160	11,910	12,110	11,830
Overall Width	mm	3,350	3,490 (2,990)* ¹	
Overall Height	mm 3,620	4,240	3,630	4,290

*Power Boost engaged ¹ For transportation



SK850_{LC}

Model		SK850LC	
		Standard Boom	Mass Excavation
Bucket Capacity	m³	3.5	5.4 (ME)
Engine Power (ISO 14396)	kW/min¹	380/1,800	
Operating Weight	kg	81,700 - 83,500	81,800 - 83,600
Bucket Digging Force	kN	403	432
Arm Crowding Force	kN	311	351
Overall Length	mm	14,530	13,590
Overall Width	mm	4,440/3,400	
Overall Height	mm	3,770	

PERFORMANCE × DESIGN

Performance Design

New SR Series excavators have realised a completely new value by harmonising PERFORMANCE – greater efficiency and productivity with an increased power and speed and DESIGN – operator-based operability and comfort, refusing to accept any compromises.

In pursuit of unique and matchless machines which are unforgettable once you use them, KOBELCO will continue to rise to meet every challenge.



SK85MSR

Competent Performance

Our high-power engine complies with new STAGE V emission standards for SK75SR and SK85MSR.

Compared to previous models, the engine output is significantly increased, which thereby shortens the digging cycle time remarkably. It attains high performances without reducing the speed even when heavy a load is applied or when travelling on a slope.



Model :YANMAR 4TNV98CT

Engine output

Increased by **27.9%**



Digging cycle time

Shortened by **15%**

Loaded boom lifting speed

Increased by **38%**

Arm digging speed

Increased by **37%**



Hill-climbing speed

Increased by **26.9%**

* Figures show the values of SK75SR. These values are compared with the SK75SR-3E model.

SR SERIES

Elegant Design



Comfort

Our pursuit of functional beauty and aesthetic sense produced a new interior design.

Jog dial

This jog dial integrates multiple functions to realise simple operations. Even with gloved hands, the operator can set various machine conditions without stress.



LED backlights

The switches and dials have LED backlights – they provide a bright, clear view in the dark and set a luxurious mood.



10-inch colour monitor (the largest in the industry)

The easy-to-operate menu screen facilitates reading of important information. Images from the built-in cameras can be checked on the large screen, which helps secure safety.

Greater Multi-function Capabilities

Attachment mode

The flow-rate modes of the bucket, breaker, nibbler, and rotating grapple are set before delivery, which allows you to start operating immediately. Mode settings for other attachments, such as the tilt rotator, can easily be added or changed.



PERFORMANCE × DESIGN

Performance  Design



SK75SR

Performance  Design



SK85MSR

Model		SK75MSR	SK85MSR
Bucket Capacity	m ³	0.11 - 0.35	0.11 - 0.35
Engine Power (ISO 14396)	kW/min ⁻¹	53.7/ 2,100	53.7/ 2,100
Operating weight	kg	7,980	8,600
Bucket Digging Force	kN	60.2	60.3
Arm Crowding Force	kN	35.2	33.7
Overall Length	mm	6,360	6,750
Overall Width	mm	2,300	2,300
Overall Height	mm	2,570	2,570

SR SERIES

Performance  Design



SK140SR_{LC}

Performance  Design



SK140SR_L

Performance  Design



ED160 *BLADE RUNNER*

Model		SK140SR _{LC}	SK140SR _L	ED160
Bucket Capacity	m ³	0.24-0.70	0.5	0.5
Engine Power (ISO 14396)	kW/min ⁻¹	86/2,200	86/2,200	86/2,200
Operating weight	kg	16,200	17,100	17,000
Bucket Digging Force	kN	105.4	105.4	105.4
Arm Crowding Force	kN	64.0	64.0	64.0
Overall Length	mm	7,530	7,460	8,550
Overall Width	mm	2,590	2,840	2,590
Overall Height	mm	2,870	3,050	3,020

PERFORMANCE × DESIGN



SK380SRLC of KOBELCO has realised a completely new value by harmonising PERFORMANCE – greater efficiency and productivity with an increased power and speed and DESIGN – operator-based operability and comfort, refusing to accept any compromises. In pursuit of unique and matchless machines which are unforgettable once you use them, KOBELCO will continue to rise to meet every challenge.



SK380SRLC

Exceptional Performance

KOBELCO engines comply with Stage V Final emissions regulations

Hino engines are renowned for fuel efficiency and environmental performance, and KOBELCO has tuned them specifically for construction machinery. The high-pressure common rail fuel injection system, the variable-geometry (VG) turbocharger, and the exhaust gas recirculation (EGR) system reduce particulate matter (PM) while the large EGR cooler greatly reduces the formation of Nitrogen Oxide (NOx) gases.

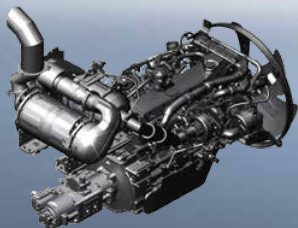

Model : HINO J08 EYD

Engine output

200 kW / 2,100 min⁻¹

ISO 14396: without fan)

Short radius design occupies only one lane of highway



In addition to excellent lifting and digging performance, the SK380SRLC has adopted the attachment mode for a variety of tasks such as breaking and operates effectively even in narrow spaces as a single highway lane. Moreover, the cab permits operators to concentrate on work in a wide and comfortable space.

Independent Travel

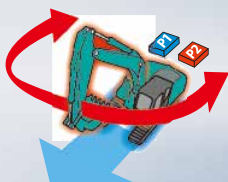

Automatic Independent Travel dedicates one hydraulic pump to travel and one to the attachment on a continuous basis, allowing for a smooth and constant movement speed even while swinging or using the boom or attachment. With Independent Travel, safely carrying a large pipe across a job site is a breeze.

Heavy Lift



High hydraulic pressure (Heavy Lift) means greater lifting power, at close radius, allowing for smooth and steady operation while moving heavy objects.

SR SERIES



SK230SR_{LC}



SK270SR_{LC}

Model		SK230SR _{LC}	SK270SR _{LC} SK270SR _{NLC}
Bucket Capacity	m ³	0.8	0.8
Engine Power (ISO 14396)	kW/min ⁻¹	124/2,000	124/2,000
Operating weight	kg	23,800	25,400/25,100
Bucket Digging Force	kN	120/132*	143/157*
Arm Crowding Force	kN	88/96.8*	102/112*
Overall Length	mm	8,830	8,970
Overall Width	mm	2,990	3,190/2,990
Overall Height	mm	3,160	3,180

* Power Boost engaged

NEW



SK380SR_{LC}

Model		SK380SRLC
Bucket Capacity	m ³	1.2
Engine Power (ISO 14396)	kW/min ⁻¹	200/2,100
Operating weight	kg	36,800
Bucket Digging Force	kN	189/208*
Arm Crowding Force	kN	126/139*
Overall Length	mm	9,980
Overall Width	mm	3,190
Overall Height	mm	3,300

*Power Boost engaged

SPECIAL ATTACHMENT

Long Reach Attachment

Long reach attachment is ideally suited to dredging, leveling, and other long reach operations.



Model		SK210LC	SK210HLC	SK260LC
Bucket Capacity	m ³	0.45	0.45	0.4
Engine Power (ISO 14396)	kW/min ⁻¹	124/2,000	124/2,000	138/2,100
Max. Digging Reach	mm	15,820	15,820	18,530
Operating Weight	kg	23,100	23,300	27,800
Overall Length	mm	12,690	12,690	14,520
Overall Width	mm	2,990	2,990	3,190

Two-Piece Boom

The two-piece boom provides a wide working range on a mid-size machine that can work in compact spaces.



Model		SK85MSR	SK140SRLC	SK180LC/SK180N	SK210LC/SK210HLC/SK210NLC SK210SNLC/SK210HNLC/SK240SN	
Max. Digging Reach	mm	8,010	8,800	8,840	10,070	
Max. Digging Height	mm	8,160	9,540	10,050	11,230	
Max. Digging Depth	mm	4,570	5,710	5,600	6,420	
Model		SK230SRLC	SK270SRLC/ SK270SRNLC	SK260LC/ SK260NLC	SK300LC/ SK300NLC	SK350LC/ SK350NLC
Max. Digging Reach	mm	9,985	10,360	10,670	10,950	11,350
Max. Digging Height	mm	11,330	11,950	11,670	11,690	12,650
Max. Digging Depth	mm	6,625	6,990	6,810	6,900	7,200

Offset Boom

In its offset boom configuration, the SK75SR/140SRLC couples its tiny rear swing radius with an offset boom function that allows it to operate with even greater efficiency in extremely limited work areas.

Performance  Design



SK75SR

Performance  Design



SK140SR_{LC}

Model		SK75SR			SK140SRLC		
Operating Weight	kg	8,000			16,700		
Offset Volume (L/R)	mm	1,030/1,340			1,170 / 1,180		
Offset		Max. Left	Center	Max. Right	Max. Left	Center	Max. Right
Max. Digging Reach	mm	6,390	6,750	6,050	7,180	7,600	7,160
Max. Digging Height	mm	7,400	7,720	7,110	7,750	8,090	7,740
Max. Digging Depth	mm	4,240	4,600	3,900	4,520	4,920	4,500

RECYCLING MACHINE

Car-Dismantling Machines

The specialized machine for dismantling end-of-life cars can efficiently take apart complex engine blocks, remove hard components and harnesses, and cut up, pick out and sort parts.



Base Machine	SK210D CD	
Nibbler Type	KV800PR	
Crusher Force (tooth - jaw tip)	kN	372
Cutting Force (center)	kN	882
Crusher Mouth Width	mm	800
Working Height of Clamp Arm	mm	1,770
Operating Weight	kg	27,400

Multi-Dismantling Machines

Fitted with a grapple with a wide jaw to secure hold of differently-shaped items. This one machine can be used to break up and separate auto engines, household appliances, industrial machinery and similar equipment.



Base Machine	SK140SRD MD	SK210D MD
Nibbler Type	KHE750PR-2	KVE720PR
Crusher Force (tooth - jaw tip)	kN	196
Cutting Force (center)	kN	539
Crusher Mouth Width	mm	720
Working Height of Clamp Arm	mm	2,000
Operating Weight	kg	30,300

Building Demolition

With efficient working and safer operation, and a design that allows easy disassembly and transport, these attachments speed up all aspects of demolition work, for improved productivity and efficiency.



Ultra Long Attachment Specifications



Base Machine		SK350DLC	SK400DLC		SK550DLC	
Attachment		6.1 m arm	6.1 m arm	8.7 m arm	6.1 m arm	8.7 m arm
		3.5 m insert	3.5 m insert	2.4 m insert	3.5 m insert	3.5 m insert
Max. Working Height (arm top)	mm	20,990	21,110	24,740	24,990	27,530
Max. Permissible Working Reach (arm top)	mm	12,500	12,500	13,000	15,090	15,550
Operating Weight (with top attachment)	kg	44,100	46,800	47,600	60,500	60,900
Max. Tool Weight	kg	2,600	3,000	2,600	3,000	2,600

Separate Boom Specifications



Base Machine		SK350DLC	SK400DLC	SK550DLC
Attachment		Large diameter jib cylinder	Large diameter jib cylinder	Large diameter jib cylinder
Max. Working Height (arm top)	mm	13,560	13,680	14,620
Max. Working Depth (arm top)	mm	6,320	6,210	6,290
Max. Permissible Working Reach (arm top)	mm	10,200	10,200	11,200
Operating Weight (with top attachment)	kg	44,400	47,100	62,400
Max. Tool Weight	kg	4,000	4,000	5,300

Power Meets Efficiency

In 2006, KOBELCO developed the world's first hybrid machine full hydraulic excavator in the history of hydraulic excavators. The SK210HLC-10, the latest model, is equipped with not only the hybrid technology developed and nurtured by KOBELCO but also a large-capacity lithium-ion battery for the first time in the industry. The technology of KOBELCO which knows hybrid machines well has enabled a compact but high-power assist, evolving its hybrid machines into "genuine hybrid machines" in terms of fuel efficiency and productivity. To the new stage. The hybrid machines of KOBELCO greatly exceed the hybrid standards that KOBELCO has established.



New Hybrid System

KOBELCO's original hybrid system has further evolved. The newly adopted swing electric motor provides operability unique to a hybrid machine. Furthermore, the large generator motor driven by the large-capacity lithium-ion battery constantly assists the engine, greatly reducing the engine load. The new hybrid system effectively supports fuel efficiency and power for swinging, digging, and traveling, thus realizing a workload which far exceeds that of conventional machines.



Model		SK210HLC
Bucket Capacity	m ³	0.8
Engine Power (ISO 14396)	kW/min ⁻¹	124/2,000
Operating Weight	kg	22,100
Bucket Digging Force	kN	143/157*
Arm Crowding Force	kN	102/112*
Overall Length	mm	9,600
Overall Width	mm	2,990
Overall Height	mm	3,060

*Power Boost engaged

KOMEXS

KOMEXS is a web-based programme that enables you to monitor your Kobelco machine remotely.



Direct Access to Operational Status

Location Data

Accurate location data can be obtained even from sites where communications are difficult.

Operating Hours

A comparison of operating times of machines at multiple locations shows which locations are busier and more profitability.

Operating hours on site can be accurately recorded, for running time calculations needed for rental machines, etc.

Fuel Consumption Data

Data on fuel consumption and idling times can be used to indicate improvements in fuel consumption.

Graph of Work Content

The graph shows how working hours are divided among different operating categories, including digging, idling, traveling, and optional operations (N&B).

Graph of Machine Duty Cycles

Security System

Engine Start Alarm

The system can be set an alarm if the machine is operated outside designated hours.

Area Alarm

It can also be set so that an alarm if the machine is moved out of its designated area to another location.

Maintenance Data and Warning Alerts

Machine Maintenance Data

Provides maintenance status of separate machines operating at multiple sites.

Maintenance data is also relayed to KOBELCO service personnel, for more efficient planning of periodic servicing.

SR SERIES MINI

Compact Yet Tough Mini

Mini excavators are the machines of choice for small jobs where space is limited. In addition to minimized tail swing radius, their excellent toughness and maneuverability have greatly broadened their usefulness. Now with upgraded hydraulic technology, KOBELCO has packed even more digging power into the SR series minis, for unprecedented performance in all types of operation. Innovation never stops: the new dozer blade shape makes dozing much more efficient. But that's not all. Our engineers have kept the environment in mind, too, ensuring that SR machines clear all the latest emissions standards. KOBELCO minis deliver more performance packed into less space than ever before.

New Dozer-Blade Shape

KOBELCO's unique blade design solves this problem by forming the earth into an arc that always falls forward. Because this prevents earth from falling behind the blade, only "one pass" is needed. (Patent pending)

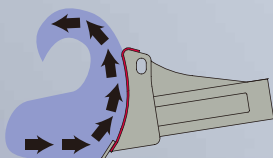

iNDr Cooling System:

SK28SR, SK30SR, SK35SR, SK50SRX, SK58SRX

The highly airtight engine compartment and the offset duct contribute to noise reduction. The iNDr filter fitted in front of the cooling system ensures easy cleaning. The iNDr system on the SR Series mini excavators features air intake at the front of the machine and air exhaust underneath. It functions in the same way as the iNDr System on the SR series machines.

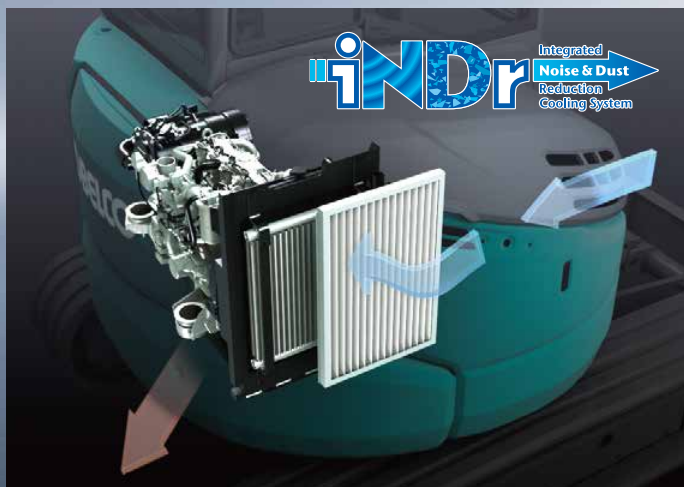



SK10SR



SK17SR



SK25SR



SK28SR



SK30SR



SK35SR



SK50SRX



SK58SRX

Model	SK10SR	SK17SR	SK25SR	SK28SR	SK30SR	SK35SR	SK50SRX	SK58SRX
Bucket Capacity	m ³	0.022	0.044	0.08	0.08	0.09	0.11	0.14
Engine Power (ISO 14396)	kW/min ⁻¹	6.1/2,000	10.4/2,200	15.2/2,500 ^{*1}	17.8/2,400	17.8/2,400	17.8/2,400	29.1/2,400
Machine Mass	kg	1,065	1,665*/1,555	2,670*/2,565	2,950*/2,800	3,380*/3,220	3,770*/3,630	4,810*/4,660
Bucket Digging Force	kN	10.8	15.2	24.5	24.7	27.7	27.8	35.6
Arm Crowding Force	kN	6.2	8.7	14.7	16.6	19.1	22.4	20.9
Overall Length	mm	2,880	3,490*/3,470	4,110	4,510	4,730	4,820	5,280
Overall Width	mm	750/980	1,090/1,320	1,500	1,550	1,550	1,700	1,960
Overall Height	mm	2,190	2,350	2,530	2,510	2,510	2,510	2,560

^{*1} Engine power for SK25SR: value of ISO 9249 ^{*} Cab specs.

SK SERIES MINI

Full-sized Job With A Compact Machine

Mini Excavators are being used more frequently in confined spaces such as residential areas and buildings. But smallness alone isn't enough to satisfy users, who are also demanding greater stability and tip-top operating performance.

The KOBELCO SK Series mini excavators answer this need with a high-output engine that provides plenty of power for tough, efficient operations. These machines also deliver excellent stability, and make the operator's life a whole lot easier with a well-designed, comfortable cab. In short, the SK Series mini excavators are ideal machines for those who want powerful, basic functions and durable reliability.

When you need to do a full-sized job with a compact machine, SK Series mini excavators are your answer.

Self-cleaning/Retractable Crawler Frames: SK08, SK18, SK10SR and SK17SR

The hydraulic retractable side frames are strong and durable, as well as self-cleaning.

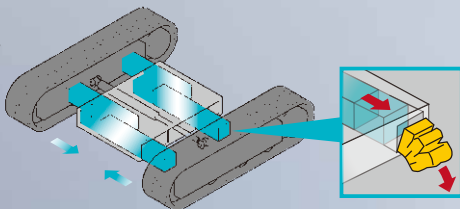

* SK10SR and SK17SR in SR Series MINI also feature these functions.

Comfortable Cab

The plenty legroom allows the operator to work comfortably for long hours.

The control lever, wrist rests, travel lever and control panel are all positioned for maximum ease of use and operator comfort.



Photo: SK18

SK08



SK18



SK22



SK26



Model		SK08	SK18	SK22	SK26
Bucket Capacity		m ³	0.022	0.05	0.050/0.06
Engine Power (ISO 14396)	kW/min ⁻¹	7.7/2,400*1	9.9/2,100	13.8/2,200	18.1/2,400
Machine Mass	kg	1,035	1,900*/1,760	2,185*/2,045	2,600*/2,460
Bucket Digging Force	kN	10.0	15.2	18.6	24.5
Arm Crowding Force	kN	5.9	7.4	11.8	14.5
Overall Length	mm	2,625	3,775	4,090	4,470
Overall Width	mm	680/840	980/1,320	1,380	1,500
Overall Height	mm	2,200	2,280	2,360	2,435

*1 Engine power for SK08: value of ISO 9249 * Cab specs.

Note: This catalogue may contain attachments and optional equipment that are not available in your area. And it may contain photographs of machines with specifications that differ from those of machines sold in your areas. Please consult your nearest KOBELCO distributor for those items you require. Due to our policy of continuous product improvements all designs and specifications are subject to change without advance notice.
Copyright by **KOBELCO CONSTRUCTION MACHINERY CO., LTD.** No part of this catalogue may be reproduced in any manner without notice.

KOBELCO CONSTRUCTION MACHINERY EUROPE B.V.

Veluwezoom 15
1327 AE Almere
The Netherlands
www.kobelco-europe.com

Enquiries To: